

HSF

TECHNICAL SPECS:

Current Rating: 1.0AMP
 Contact Resistance: 10mΩ Max
 Dielectric Strength: Min 500VRMS
 Mechanical Life: Min 500 cycles
 Mating Pin: $\phi 0.38$ to $\phi 0.50$ mm
 Forces: (polished steel gauge $\phi 0.41$ mm)
 Insertion: 250g Max/Pin, Withdrawal: 25g Min/Pin
 Operation Temperature: -40°C to $+105^{\circ}\text{C}$

Sleeve: Brass CuZn36Pb3(C36000), Sn over Ni
 Contact Clip(6 finger): BeCu(C17200), Au or Sn over Ni
 Insulator Material: PPS+30%G.F(UL94V-0)

Ordering Information

3524-383 XX M XX 060 X 1

No. of Pin	Contact Plating	Packing
2-50PIN	S0=Gold Flash/Tin	T=Tube
	S3=10u"Gold/Tin	A=Tray
	S4=15u"Gold/Tin	R=Tape&Reel
	S5=30u"Gold/Tin	
	SN=Tin	

Item	Pitch	Mating
Standard	1.27	3514
Alternate		

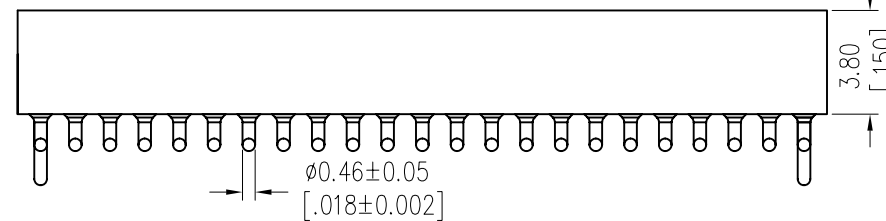
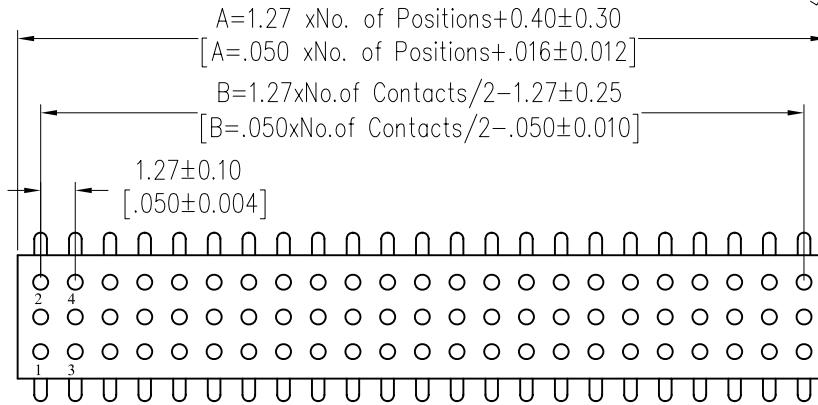

Recommended P.C.B Layout(Top Side)

(PCB BOARD TOLERANCE ± 0.05)

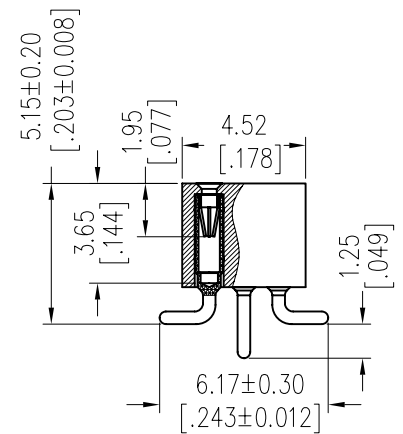
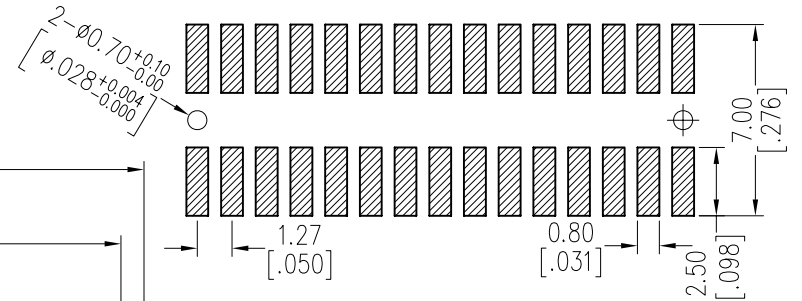

REV	DATE	MODIFICATION DESCRIPTION	CHANGE	OPERATION	DRAW	DATE	SCALE	FIT	PART NO.
				x.x ±0.40	JYHuang	2012/10/16	UNIT	mm	3524-383XXMXX060X1
				x.xx ±0.25	CHECK	DATE	SIZE	A4	
				x.xxx ±0.15	APPROVE	DATE	SHEET	1/1	TITLE: 1.27mm MACHINED FEMALE HEADER THREE ROW 180° SMT H=3.80
				Angle ± 3°			PROJ.	Customer NO.	
				DIM TOL					